

2021 IRC/2020 NEC
APPROVED

These plans have been reviewed & approved under the 2021 IRC/2020 NEC and all pertinent codes & ordinances as adopted by The City of El Paso on September 1, 2023

BY: Roberto Quiróz DATE: 8/20/2025
PROJECT #: VC25-1168

Vision Consultants
El Paso, Texas

1/4" = 1'-0"

LIVING AREA: 1514 SF
GARAGE: 395 SF
FRONT PORCH: 55 SF
PATIO PORCH: 98 SF
TOTAL: 2062 SF

FIREFOX HOMES LLC
PLAN ALICE

12349
ANSON MILLS
EL PASO TX, 79934
BLOCK 5
LOT 12

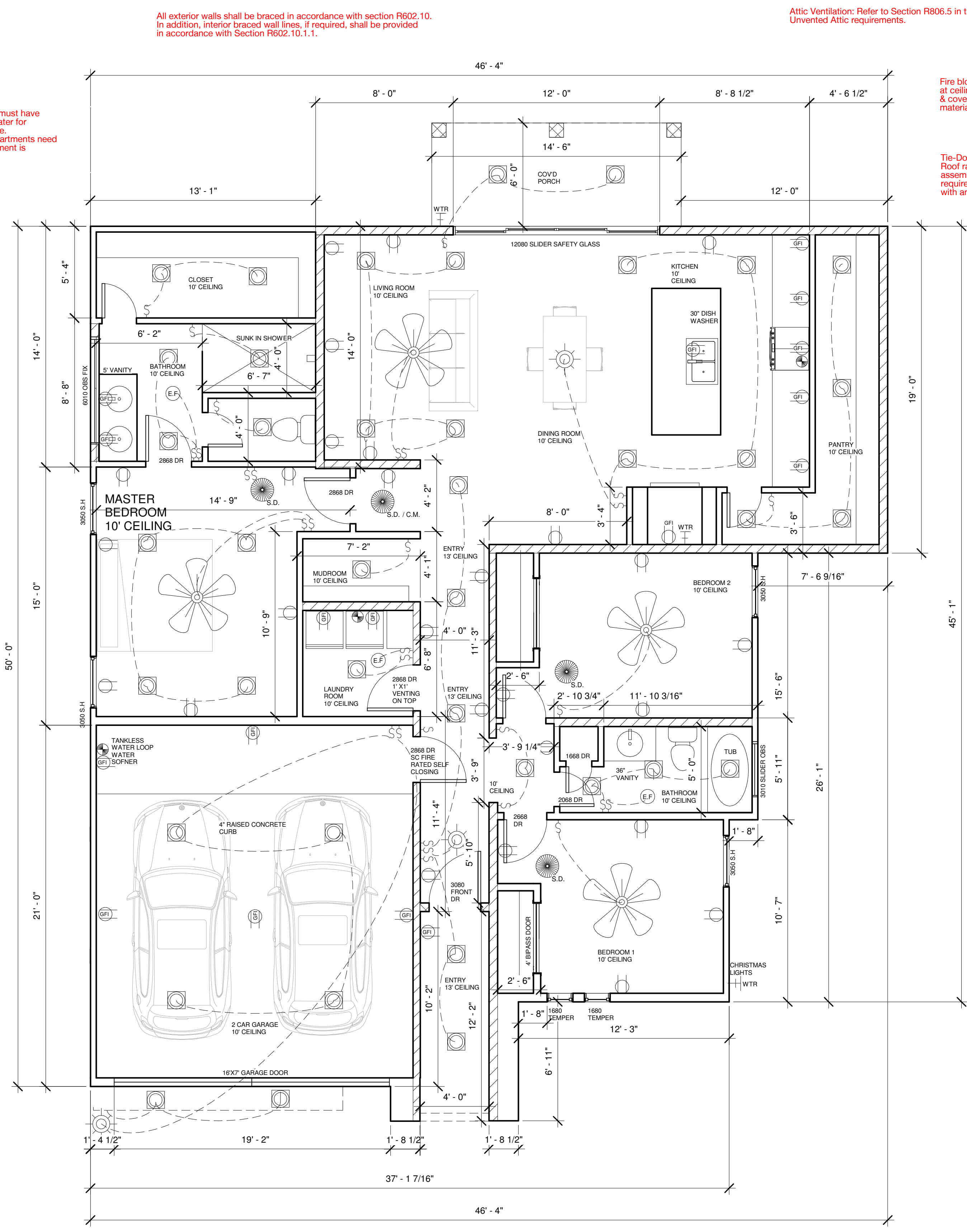

OVERALL PLAN

Fire blocking with approved materials must be provided in concealed spaces at ceiling and floor levels, horizontally not to exceed 10', soffits, drop & cove ceilings, between stair stringers, and the annular space around material penetrations of floors and ceilings.

Tie-Downs:
Roof rafters and trusses must be attached to supporting wall assemblies by connections capable of providing the resistance required in Table R802.11 (from -131 to -436 pounds per connection with an overhang increase of -53.36 pounds per linear foot).

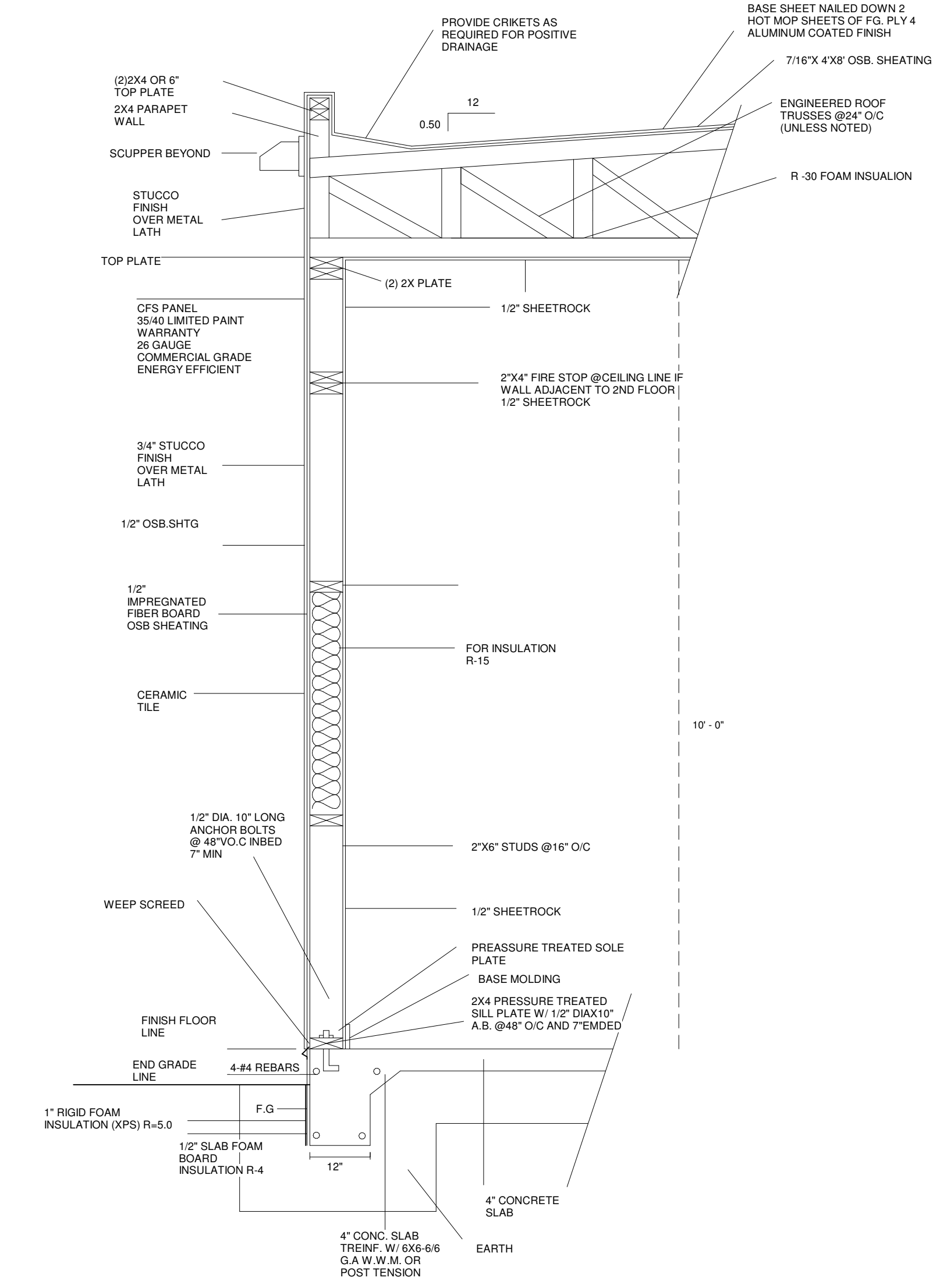

SECTION CUT
PARAPET

A minimum 0.019" (0.5mm) No. 26 galvanized sheet gage, corrosion-resistant weep screed or plastic weep screed, with a minimum vertical attachment flange of 3 1/2" shall be provided at or below the foundation plate line on exterior stud walls. The weep screed shall be placed a minimum of 4" above the earth or 2" above paved areas and shall be a type that will allow trapped water to drain to the exterior of the building. The weather-resistant barrier shall lap the attachment flange. The exterior lath shall cover and terminate on the attachment flange of the weep screed.

Water Resistive Barrier:
One Layer of #15 asphalt felt free from holes and breaks shall be applied over studs or sheathing of all exterior walls. Shall be applied horizontally, with the upper layer lapped over the lower layer not less than 2 inches. At joints felt shall overlap not less than 6 inches.

