

1/4" = 1'-0"
Scale

FIRE FOX HOMES
LLC

PLAN ELL

FIRE FOX HOMES
LLC

OVERALL FLOOR
PLAN

Project Number 1
Date 1/24/2024
Drawn By ANTONIO
Checked By Checker

A101

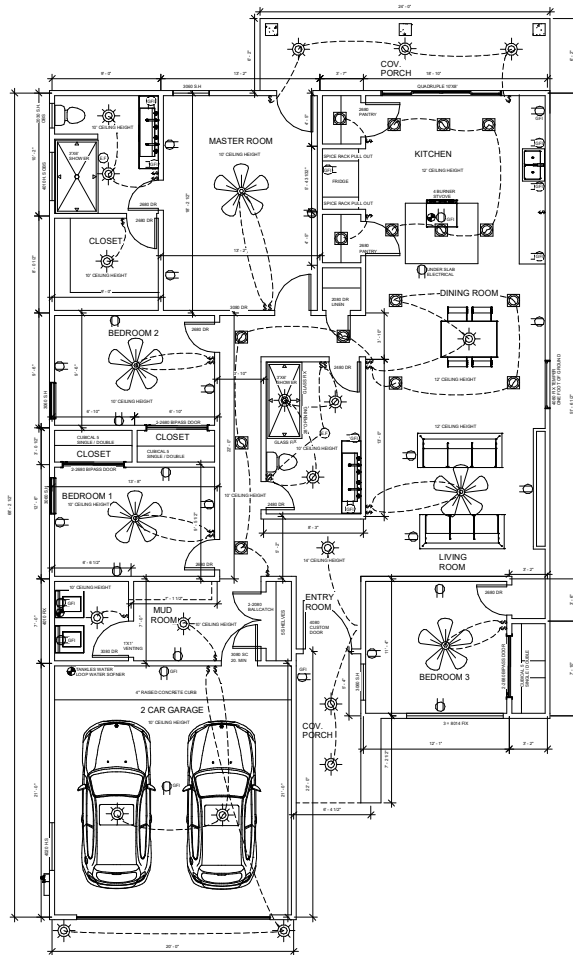

① OVERALL FLOOR PLAN
1/4" = 1'-0"

GENERAL NOTES:

-CONTRACTOR TO VERIFY LOCATION OF ALL ELECTRICAL AND PLUMBING ON BREAKFAST BAR PRIOR TO POURING

- USE AFCI PROTECTED CIRCUITS @ ALL HABITABLE SPACES

EXCEPTION:
STARTING JUNE 1ST:

KITCHEN COUNTER TOPS
BATHROOM COUNTER TOPS

-HALL WAYS

-CLOSET

-SIMILAR AREAS

-PREVIOUS AREAS AS OUTLINED IN NEC

- ALL CORNERS TO BE BRACE WITH 1/2" O.S.B PLYWOOD W/ 8D NAILS @ 8" O.C.

- ALL RECESSED LIGHTNING TO BE SEALED WHERE THEY PENETRATE THE FINISHED WALL OR CEILING MATERIAL.

- USE GFI OUTLETS AT GARAGE

- ALL DUCTS IN UNCONDITIONED SPACE TO BE R-8, INSULATION DUCTS IN CONDITION SPACE TO BE R-6 INSULATION

- ALL EXTERIOR MECHANICAL APPLIANCES TO BE RAISED 3" A.F.G.

- ALL EXTERIOR MECHANICAL APPLIANCES TO BE PROPERLY PROTECTED FROM ANY IMPACT. (USE CONCRETE FILLED STEEL PIPE BOLLARD OR OTHER APPROVED PROTECTION).

-USED RECESSED OR SURFACE-MOUNTED LED LUMINAIRES IN CLOSETS 12" AWAY FROM FRONT SHELF.

- USED GFI OUTLET IN JACUZZY TUBS.

- METAL TIES REQUIRE 6" BEYOND OPENING OF NOTCHED TOP PLATE 16 GA 1'- 1/2" GALV.

- 4"x4" STEP FLASHING REQUIRED AT ALL VERTICAL/SIDE WALLS W/ KICK OUT.

- COUNTER FLASHING REQUIRED ON PARAPET WALL

- SHOWER LINER TO BE 3" ABOVE STOOP AND OVERLAP DOOR JAMBS.

- HABITABLE ATTIC MUST HAVE 5.7 SQ.FT. EGRESS MN. 20" X 24" SMOKE + CO2

- USED JOIST HANGERS W/ GALVANIZED NAILS

- LATERAL RESTRAINT FOR ENG. WOOD JOIST & TRUSSES @ BEARING POINTS.

- ATTIC ACCESS IN AC SPACE TO HAVE BATT INSULATION AND WEATHER STRIP

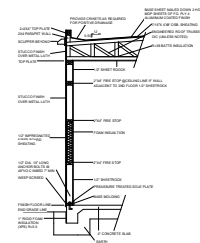

② SECTION CUT
1/4" = 1'-0"